



Series 47.00x.202



Description

Direct acting 2/2 way solenoid valve with different orifice sizes for control of neutral gases and liquids. The plunger of the magnetic system is protected by spatial separation from the medium. In particular, the low dead space is a further advantage of the lever valves.

Valves of this design are single chamber valves with 6 or 8 mm push-fit connections.

The coil system can be customised for common voltage and frequency ranges on request. Electrical operating safety is achieved by insulation class F and can be supported by an integrated protective circuit.

Due to the use of high quality materials, the valve is applicable for high ambient and medium temperatures up to 98 °C.

Ideally suited for dosing applications. The good thermal separation between the fluid path and solenoid also allows the use of temperature sensitive media, such as in the medical technology or analytics.

Applications

- Hot / cold drink dispensers
- Tank or boiler draining
- Medical engineering
- Laboratory / analysis equipment
- Industrial applications

Materials

Valve body	PPSU
Plunger guide	Stainless steel
Plunger and spring	Stainless steel
Membrane and sealings	EPDM FKM on request
Coil coating	PBT or epoxy resin

⚠ PPSU valve bodies may not come in contact with:

acetone, ethers, ketones, aromatic hydrocarbons, chlorinated hydrocarbons, acids and oxidizing anaerobic adhesives.

Characteristics

- Direct acting
- Medium separated
- Minimal dead areas in valve body
- Long term performance capability
- No minimal pressure required
- Suitable for food and hot water appliances (98 °C)
- Easy to assemble and service
- Low power consumption
- Any fitting position
- High operating safety through the use of high quality materials and 100% final testing of the products

Possible approvals

- UL
- NSF 759
- Other approved versions available on request

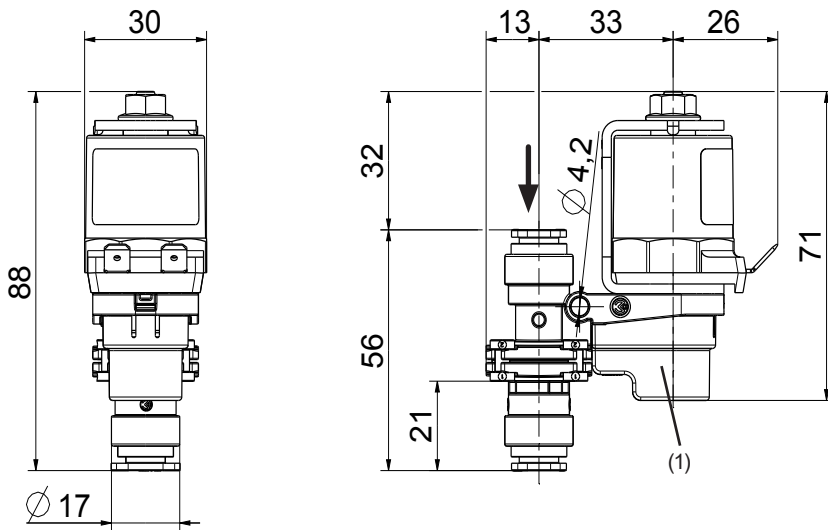

! Connection hoses should be installed with the lowest possible mechanical stress acting on the inlet and outlet connections!
To ensure the function of the valve, the cap (1) must be installed at any time.

Technical Data

Type	lever solenoid valve	
Construction	2/2-way single chamber valve, direct acting, media separated	
Function	normally closed	
Fitting position	any, preferably with coil upwardly	
Media	cold and heated potable water and physically and chemically similar media	
T-Medium	98	°C max.
T-Ambient	70	°C max.
Coil type	MS.006, MS.024, MS.025	
Nominal voltages	24	V DC
	24	V AC 50/60 Hz
	other voltages on request	
Voltage tolerance	±10%	
Duty cycle	100%	
Nominal power	24 V DC	9,5 W
	24 V AC	8,0 W
Protection Type	IP 00 up to IP 68 according to EN 60529	
Coil connections	flat tabs 6,3 x 0,8 mm plug socket according to EN 175301-803 (IP65), several cable connections (IP67, IP68)	
Insulation class	F	according to EN 60730
Protection class	I	according to EN 60730 (for incorporation in class I)

Options

Type		Ending
F	Push-fit connection Ø 6 mm	
J	Push-fit connection Ø 8 mm	

DN	Connector combination	Membrane	Nominal voltage	Flow factor Kv P-A	Flow factor Kv A-P	p-Operating	ID
2	J,J	EPDM	24 V DC	2.0 l/min	2.5 l/min	0-8 bar	090319
3	J,J						090321
	J,J		24 V AC 50/60Hz	3.5 l/min	4.1 l/min	0-5 bar	090322
4	F, F	FKM	24 V DC	3.4 l/min	3.7 l/min	0-3,0 bar	090313
	F, F	EPDM					090324
	J,J	EPDM	24 V AC 50/60Hz	3.8 l/min	4.3 l/min	0-3,5 bar	090314 090315

Other versions upon requests.

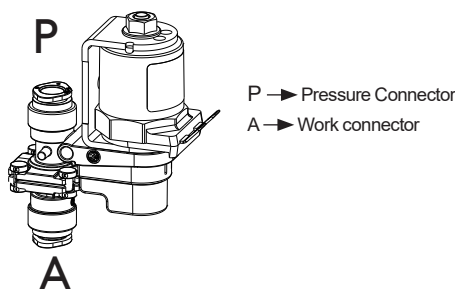

MS 6 (IP00)	
MS 24 (IP65)	
MS 25 (IP67, IP68)	



47.002.202
47.003.202

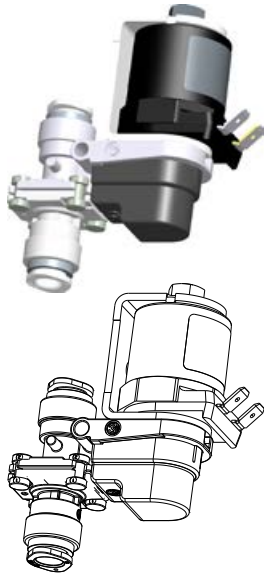

Typical performance curve DN 2, DN 3

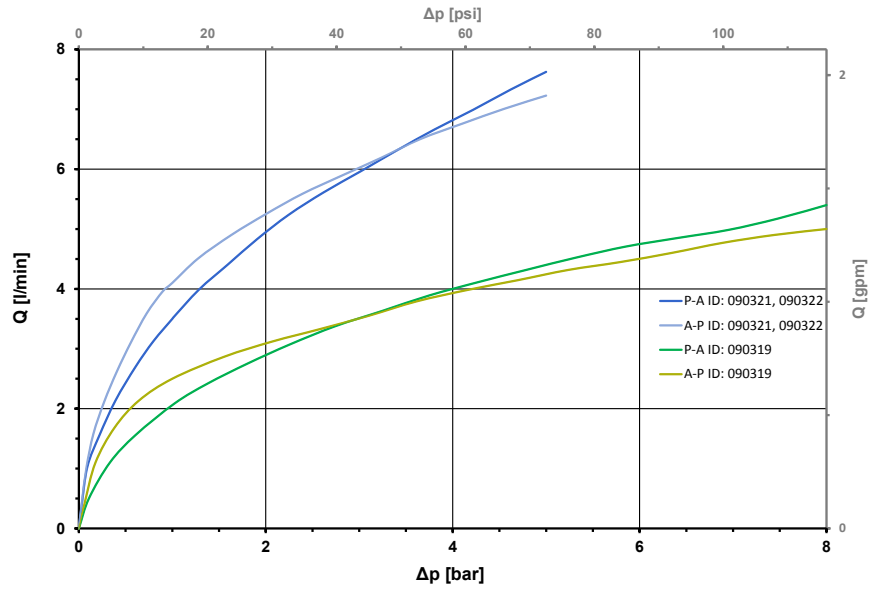

47.004.202



Typical performance curves DN 4

