

2/2-way lever valve NO

Product Information



A. u. K. Müller

Solenoid valves
Control valves
Special valves and systems

A. u. K. Müller GmbH & Co. KG
Dresdener Str. 162
D-40595 Düsseldorf/Germany

Tel.: +49(0)211-7391-0
Fax: +49(0)211-7391-281

e-mail: info@akmueller.de
Internet: www.akmueller.de

Series 47.00x.282



Characteristics

- Direct acting
- Medium separated
- Long term performance capability
- Works from zero pressure
- Easy to assemble and service
- Low power consumption
- Any fitting position
- Minimised dead areas
- High operating safety through the use of high quality and 100% final testing of the products

Applications

- Hot / cold drink dispensers
- Tank or boiler draining
- Medical engineering
- Industrial appliances
- Laboratory / analysis equipment

Possible approvals

Approved versions available on request:

- NSF 169
- UL
- Others on request

Description

Direct acting 2/2 way solenoid valve with different orifice sizes, normally open, for control of neutral gases and liquids. The plunger of the magnetic system is protected by spatial separation from the medium. In particular, the low dead space is a further advantage of the lever valves.

Valves of this design are single chamber valves with 6 or 8 mm push-fit connections.

The coil system can be customised for common voltage and frequency ranges on request. Electrical operating safety is achieved by insulation class F and can be supported by an integrated protective circuit.

Due to the use of high quality materials, the valve is applicable for high ambient and medium temperatures up to 98 °C.

Ideally suited for dosing applications. The good thermal separation between the fluid path and solenoid also allows the use of temperature sensitive media, such as in the medical technology or analytics.

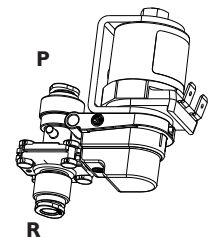

typical performance curve

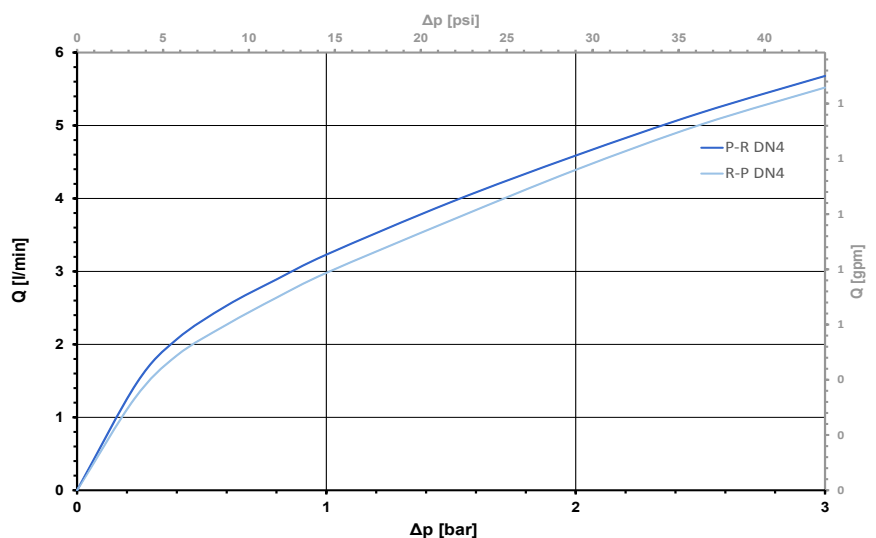



Series 47.00x.282

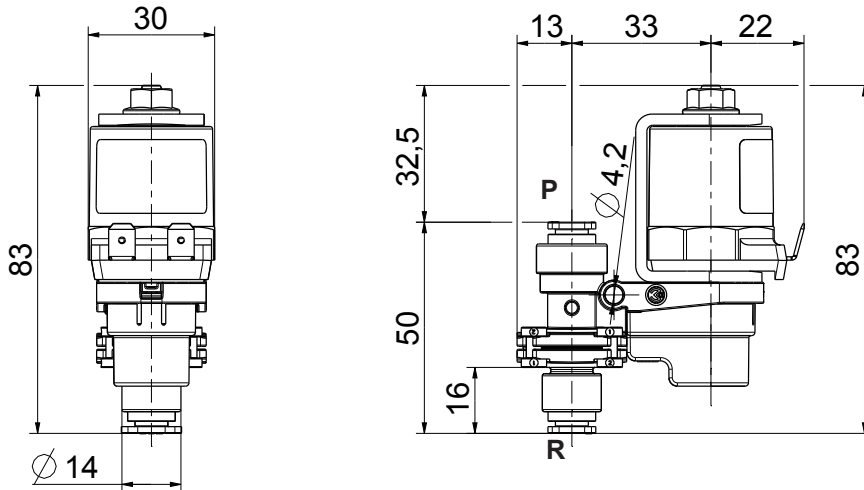

Technical Data

Type	lever solenoid valve	
Construction	2/2-way valve, direct acting	
Function	NO (normally open)	
Fitting position	any	
Media	cold and heated potable water and physically and chemically similar media	
T-Medium	98	°C max.
T-Ambient	60	°C max.
DN	4 2	mm mm on request
p-Operating	0 - 3	bar
Coil type	MS.006, MS.024, MS.025	
Nominal voltages	24	V DC
	other voltages on request	
Voltage tolerance	+10 % -15 %	
Duty cycle	100 %	
Nominal power	9,5	W
Protection type	IP 00 up to IP 68	
Coil connections	flat tabs 6,3 x 0,8 mm plug socket, according to EN 175301-803 (IP65), several cable connections (IP67, IP68)	
Insulation class	F	according to EN 60730
Protection class	I	according to EN 60730 (for incorporation in class I)

Materials

Valve body	PPSU
Plunger guide	stainless steel
Plunger	stainless steel
Membrane	EPDM FKM on request
Coil coating	PBT or epoxy resin

⚠ PPSU valve bodies may not come in contact with:

acetone, ethers, ketones, aromatic hydrocarbons, chlorinated hydrocarbons, acids and oxidizing anaerobic adhesives.

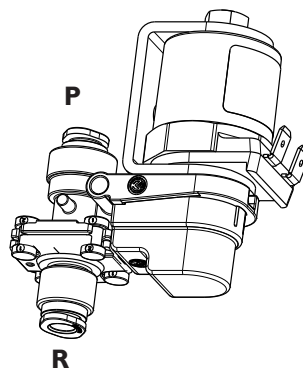

Connection hoses should be installed with the lowest possible mechanical stress acting on the inlet and outlet connections!

Options

Type		Ending
F	Push-fit connection Ø 6 mm	
K	Push-fit connection Ø 8 mm	

All other variants on request.

ID	DN	Connector	Cv-value P	Cv-value R
90316	4	Ø 6 mm push-fit connector	3,2	3,0

Other orifice sizes and connection fittings on request.

