



Series 50.00x.126



For use with cartridge valves of series 50.007.101 or 50.009.101

Characteristics

- Long term performance capability
- Easy to assemble and service
- Standard connection
- Any fitting position
- High operating safety through the use of high quality and 100% final testing of the products

Approvals

- KTW-BWGL System 1+

Description

The valve body adapter allows a variety of common inlet and outlet connections.

For use with cartridge valves series 50.007.101 or 50.009.101 a screw cap version, pressure compliant according to DIN EN 60730, is available.

The version with screw cap is also available for the manually operated cartridge valves 50.007.801 and 50.009.801.

The valve body is made of PA 6/6.

For cartridge valves of series 050. ... or 50.007.101 a screw-in adapter is provided. The screw-in version simplifies assembly, service and check of the valve.

Applications

- Sanitary fittings
- Irrigation systems
- Industrial appliances



For use with manually operated cartridge valves 50.007.801 and 50.009.801



For use with cartridge valves of series 050. ... or 50.007.101



Series 50.00x.126

For use with cartridge valves of series 50.007.101 or 50.009.101





Technical Data

Type	cartridge valve housing	
Construction	plug-in socket with screw cap	
Fitting position	any	
Media	cold and heated potable water and physically and chemically similar media	
T-Medium	5 - 70	°C.
T-Ambient	5 - 60	°C
DN	7	mm
	9	mm
p-Operating	0,5 - 10	bar
Static pressure resistance	5x p-operating / 1 min acc. DIN EN IEC 60730-2-8	
Dynamic pressure resistance	according to E-DIN 35911 section 4.8 and DVGW W534 (P) section 12.5	

Materials

Supporting housing	PA 6/6
--------------------	--------

Spare parts

Spare parts	ID	
Swivel nut for plug and valve 50.007.101 or 50.009.101	009787	
Plug with o-ring	010941	

Options

Inlet		Outlet		Length	For cartridge valves	
Ø A	A1	Ø B	B1		50.007.101	50.009.101
G 3/4	14,5	G 3/4	14,5	68,6	009056	009925
G 1/2	15,0	G 1/2	14,5	69,6	009055	on request
G 3/8	13,0	G 3/8	13,0	66,1	011682	on request
G 3/4	10,0	G 3/4	10,0	59,6	on request	



Series 50.00x.126

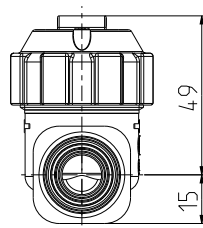
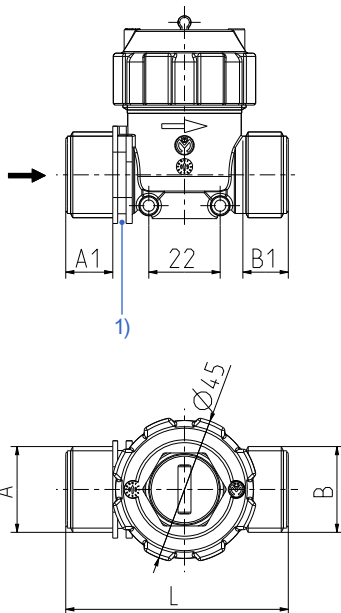
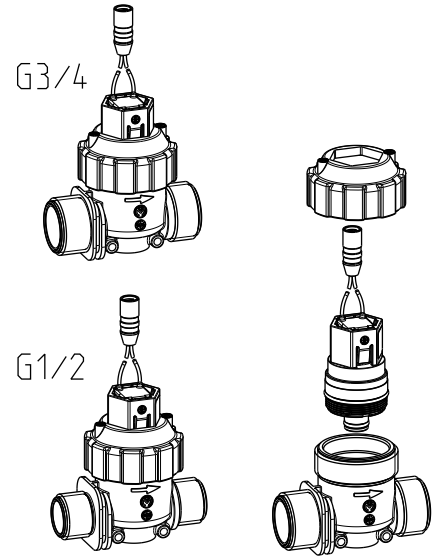
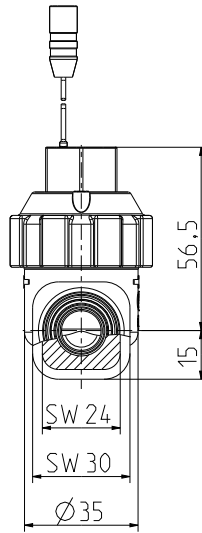
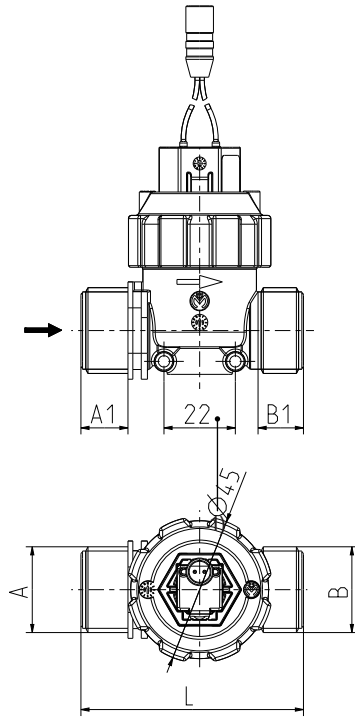

With plug

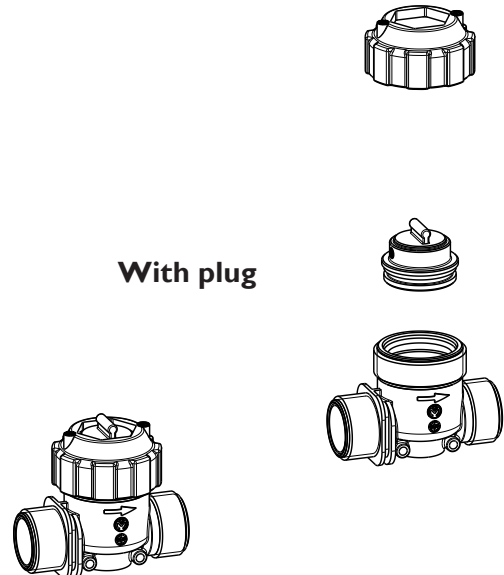

1) Fixing groove

■ For variants with shut-off valve see data sheet 52.007.126 or shut-off valve and strainer see data sheet 52.007.



Series 50.00x.126

For use with manually operated cartridge valves of series 50.007.801 or 50.009.801





Technical Data

Type	cartridge valve housing	
Construction	plug-in socket with screw cap	
Fitting position	any	
Media	cold and heated potable water and physically and chemically similar media	
T-Medium	5 - 70	°C.
T-Ambient	5 - 60	°C
DN	7	mm
	9	mm
p-Operating	0,5 - 10 bar	
Static pressure resistance	5x p-operation / 1 min acc. DIN EN IEC 60730-2-8	

Materials

Supporting housing	PA 6/6
--------------------	--------

Spare parts

Spare parts	ID	
Swivel nut for plug and valve 50.007.801 or 50.009.801	010827	
Plug with o-ring	010941	

Options

Inlet		Outlet		Length	For cartridge valves	
Ø A	A1	Ø B	B1		50.007.801	50.009.801
G 3/4	14,5	G 3/4	14,5	68,6	009056	009925
G 1/2	15,0	G 1/2	14,5	69,6	009055	on request
G 3/8	13,0	G 3/8	13,0	66,1	011682	on request
G 3/4	10,0	G 3/4	10,0	59,6	on request	



Series 50.00x.126

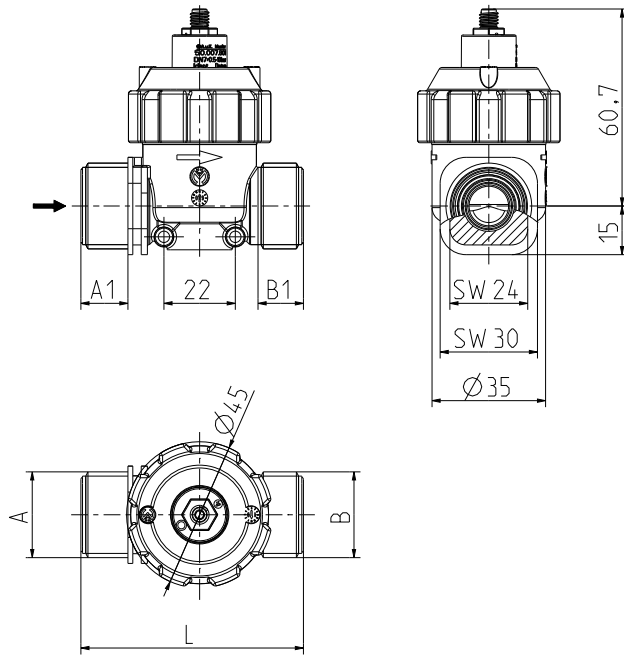

G3/4

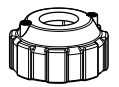
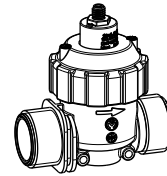

G1/2

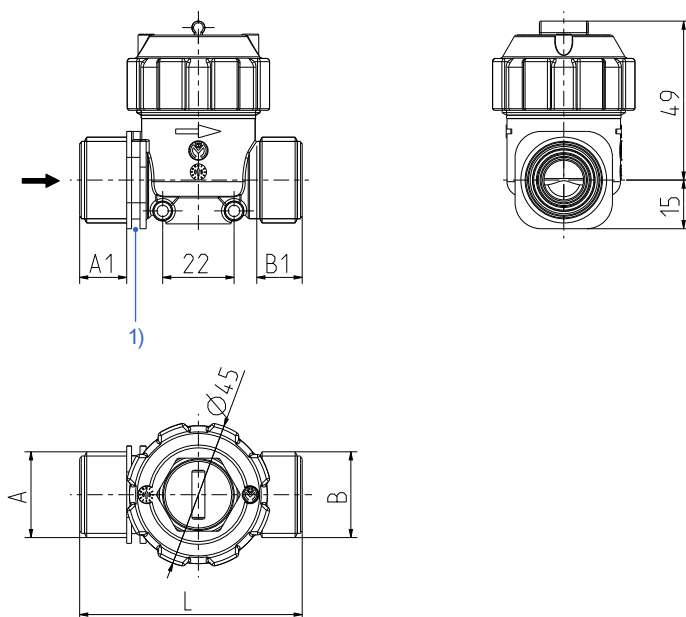
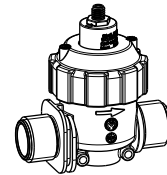

With plug

1) Fixing groove

Series 50.00x.126

 Assembly instructions

Please proceed with the installation as follows:

1

Place the cap before screwing on the valve first.

2

The cutout in the upper cap opening must be aligned with the cable exit or manual operation of the valve and must lie flush.

3

Screw cap and valve simultaneously in the housing to prevent damages caused by misalignment of the valve.

1



2



3





Series 50.00x.126

For use with cartridge valves of series 50.007.101 M28 x I



Technical Data	
Type	cartridge valve housing
Construction	Screw-in socket
Fitting position	any
Media	cold and heated potable water and physically and chemically similar media
T-Medium	5 - 70 °C.
T-Ambient	5 - 60 °C
DN	7 mm
p-Operating	0,5 - 8,0 bar
Static pressure resistance	25 bar / 1 min acc. DIN EN 15091 and DIN EN 200

Materials	
Supporting housing	PPE

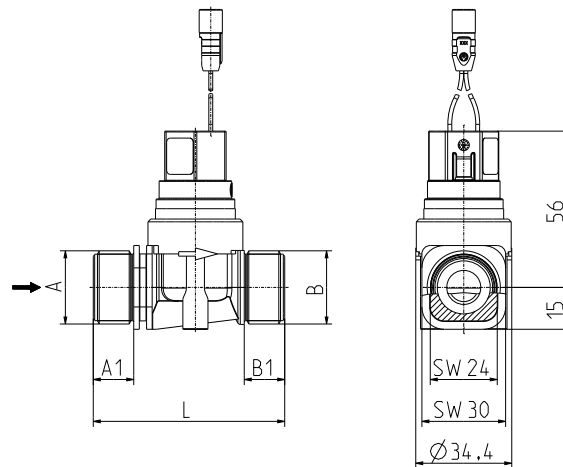

Options						
Inlet		1) Fixing groove	Outlet		Length	
A	A 1		B	B 1	L	
G 3/8	13	yes	G 3/8	13	66	
G 1/2	15	yes	G 1/2	15	70	
G 1/2	15	yes	G 3/8	13	68	on request
G 3/4	10	no	G 3/4	10	55	
G 3/4	14,5	yes	G 3/8	14,5	69	
G 3/4	18	yes	G3/4	18	76	
G 3/4	14,5	yes	G 1/2	15	69	

Further mounting variants and different angled outlets on request.

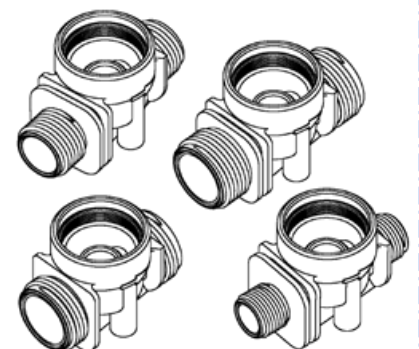



Solenoid valves
Control valves
Special valves and systems

A. u. K. Müller GmbH & Co. KG
Dresdener Str. 162
D-40595 Düsseldorf/Germany

Tel.: +49(0)211-7391-0
Fax: +49(0)211-7391-281

e-mail: info@akmueller.de
Internet: www.akmueller.de